

PIECES DETACHEES

MOYEUX suivant modèle

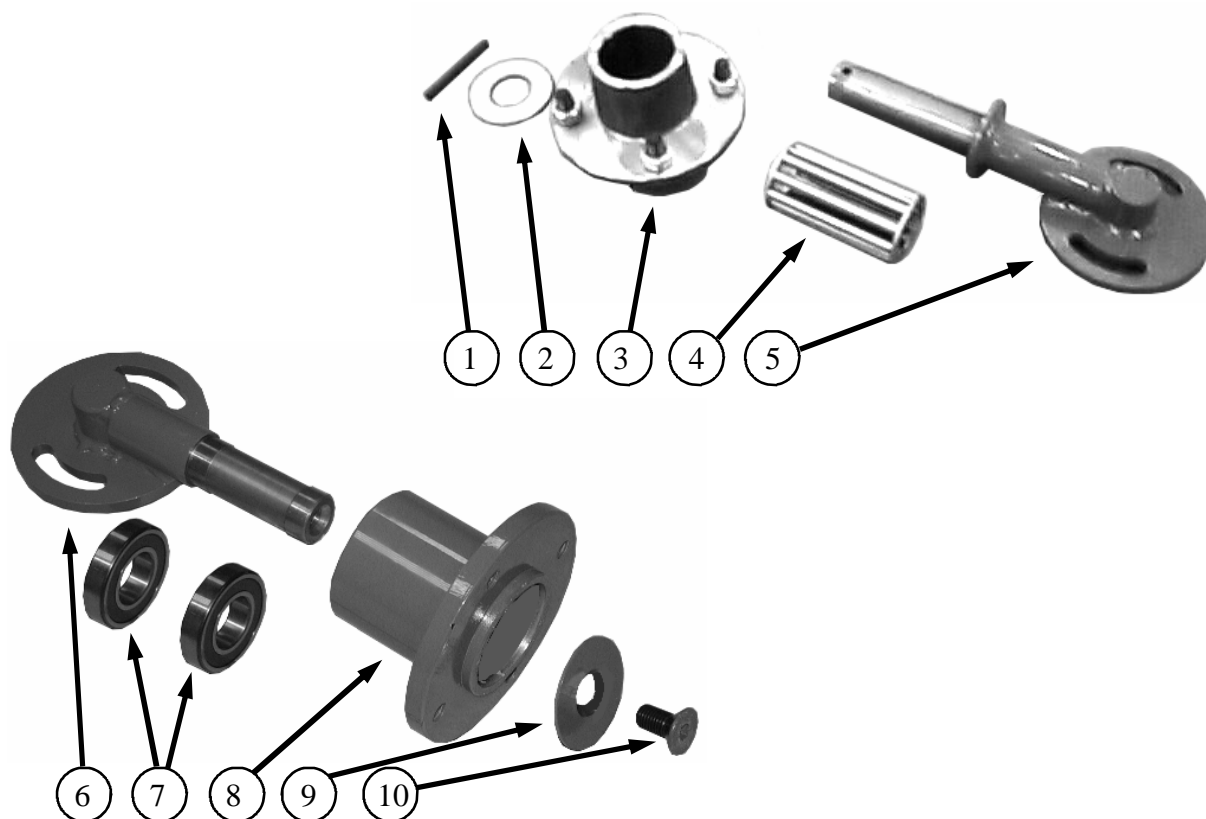

Rep.	Qté	Désignation	Référence
1	2	Elastic pin	CM220010
2	2	Flat washer	CM220020
3	2	Cast iron hub	CM220030
4	2	Roller bearing	CM220040
5	2	Rotatable pin for flat unwinder	CM220050
6	2	Rotatable pin for unwinder on arches	CM220650
7	4	Bearing	19000250
8	2	Steel hub	CM220660
9	2	Washer	CM220670
10	2	Screw	CM220680



Using the film cutter (option)

The film cutter must be used cautiously, and constant vigilance about personnel safety is necessary.

At the end of the strip, use the tractor double acting distributor to lower the harrow.

Raise the machine and move forwards to tear the plastic film. Do not raise the harrow to hold the film trapped in place by the claw.

When you are ready to start again, put the machine down making sure that the plastic film is in position under the insertion wheels and raise the harrow.



Use the flow limiter to adjust the assembly rise speed. No shocks must be applied to the machine due to an excessive speed.

The valve must be closed after the machine is used. The film cutter must be lowered to the down position if any work is done on the hydraulic circuit.





Adjustment of the reel brake

The force by which the brake is applied to the reel varies the tension of the plastic film.

More tension
Less tension

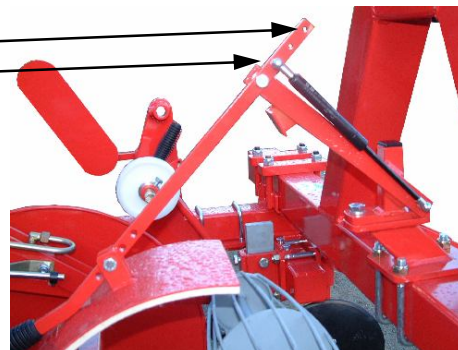

Adjusting the spindle

The position of the spindle increases or reduces the plastic tension, so that the arches are installed more or less flat. The height adjustment is not very important but it must be sufficient so that it does not touch the arches. The film tension will be installed looser as the spindle is moved forwards. The film tension will be higher and the arches will be flatter as the spindle is moved further backwards.

Insertion wheel scraper

Regularly check the condition of the scraper to avoid rising earth or sand that could damage the reel and facilitate tearing off the plastic film.



For adhesive plastics, put the outside rollers 5 cm from the reel stop (contact CM for additional rings to lock the rollers).



Working width

The working width is measured at the c/c distance of the insertion wheels.

For 2 m plastic film

c/c distance 1290 to 1320

For 2.10 m plastic film

c/c distance 1350 to 1380



Working depth

The depth to which the plastic film is buried is important. If the buried plastic is too deep it will be difficult to extract it when required, whereas if it is not deep enough there is a risk that it could easily be pulled out by the wind.

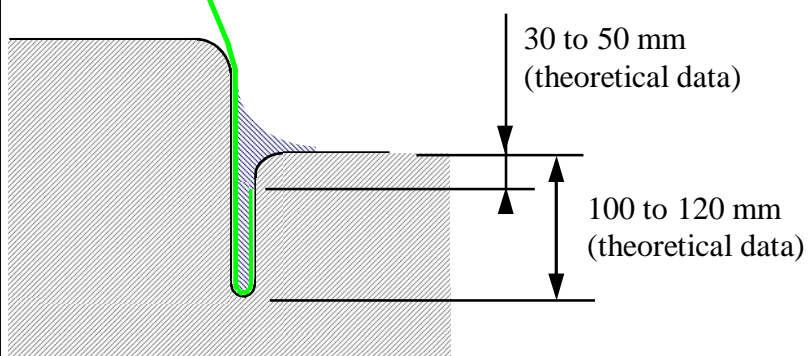

It is important that there is a plastic return when installing the cover. Otherwise the earth will not hold the film in the bottom of the groove and it will be able to slide out easily.

The plastic return must not be too long and it must remain in the ground. Otherwise, runoff water will carry away the earth that holds the film in place.

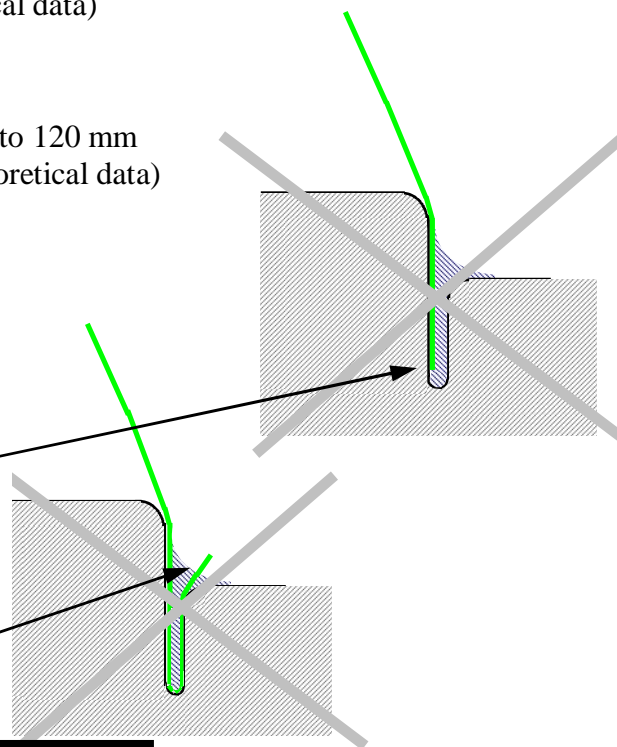

Position of the rear compaction wheels

The position of the rear wheels depends on the working depth and working conditions.

80 to 110 mm depending on the working depth of the share. The machine must be horizontal so that the height of the bottom of the share with respect to the wheel is kept constant.

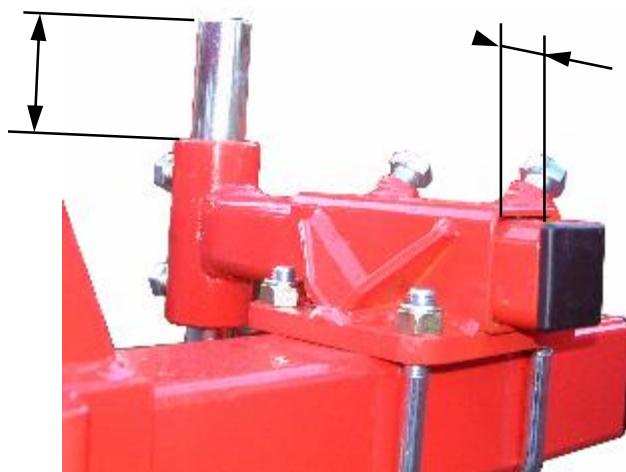

25 to 45 mm depending on the nature of the soil. The value is 45 mm for loose soils, and 25 mm for compact soils.

Move the rear wheel away from or towards the metal wheel depending on the nature of the ground (further apart for sticky or stony ground, closer for sandy ground).

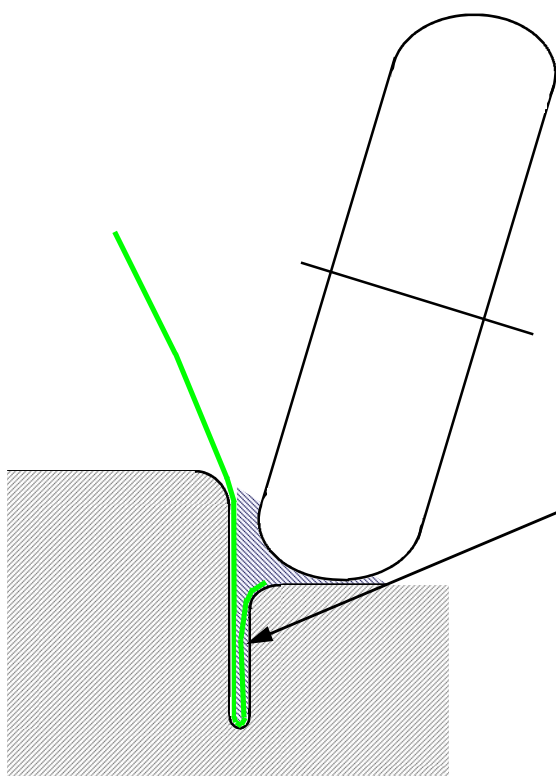

When the rear wheel passes, make sure that the groove is properly closed on the edge of the plastic to be buried. If the earth does not close the slit very well, apply more weight on the rear beam to apply more pressure on the compaction wheels.

ADJUSTMENTS FOR UNWINDER ON ARCHES

Share position

The position of the share with respect to the insertion wheel depends on the nature of the plastic and it must be correctly adjusted to avoid damaging the plastic film.

The share adjustment height **for a new share** must be as follows:

- 70 mm for a traditional plastic,
- 110 mm for sliding plastic.

In all cases, the spacing between the wheel and the share must be 10 mm. Adjust Flange Mark 1 to move the wheel forwards or backwards, and flange 2 to adjust the share height.

As the share wears, keep the adjustment values approximately constant, Figure 1 or Figure 2, by varying flanges Mark 3 and Mark 4.

Traditional plastic (Fig. 1)

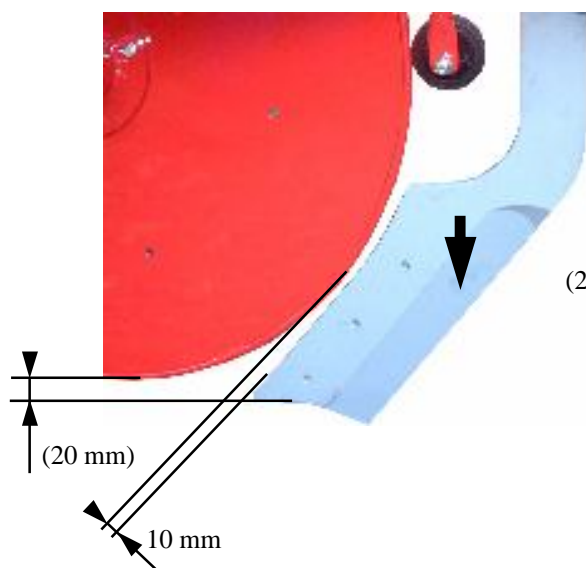

Sliding plastic (Fig. 2)

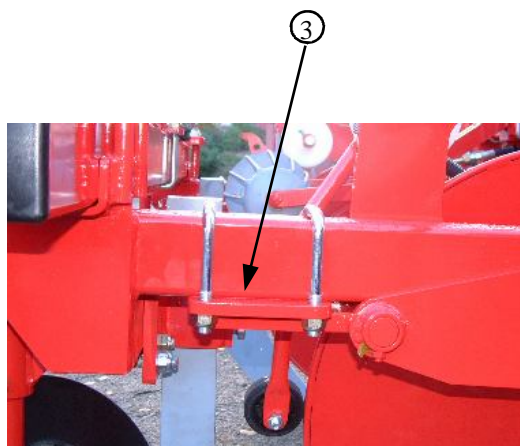
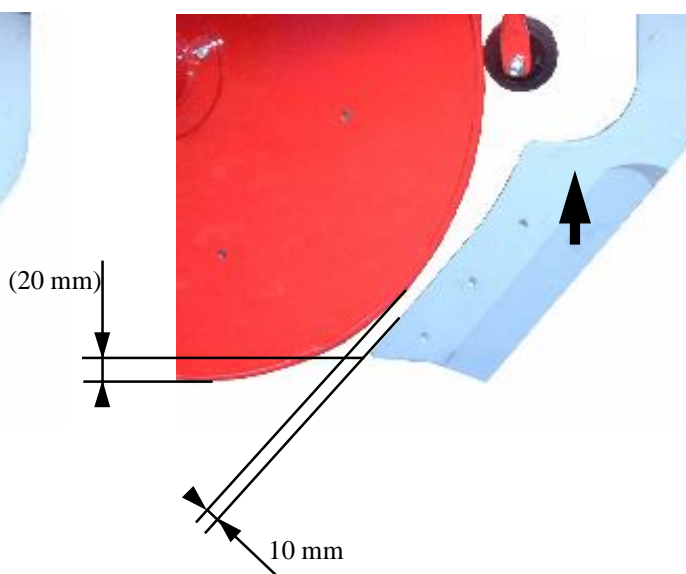

70 to 110 mm
(new shares)

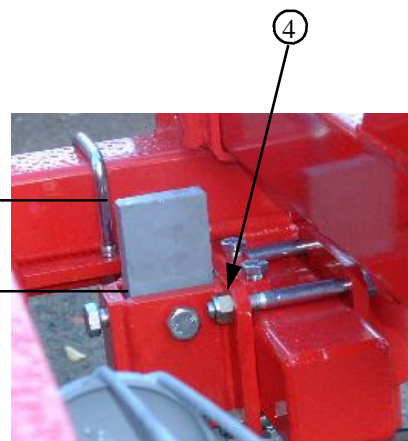



- The PVC roller must not be brought forward in front of the metallic wheel.
- The front colters (option) must not pick up more than 20 or 30 mm of earth in front of the shares
- The rear wheels must be offset by about 15 mm from the metallic wheels

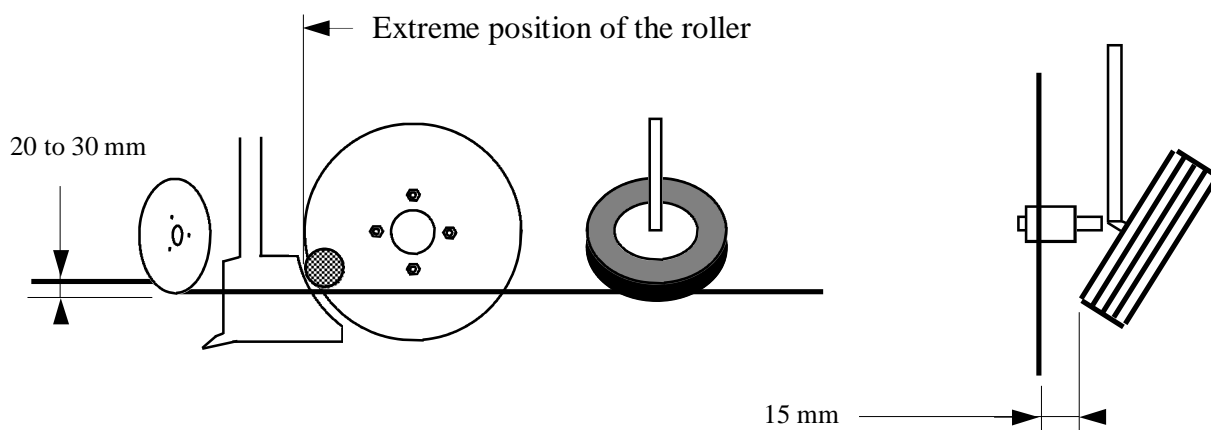

- The tension release spindle (option) releases the tension on the plastic film. The tension in the installed film can be lower when the release spindle is advanced further.
- The front roller (option) may be filled with oil to increase the compaction of the ground.
Important: the roller must always be hitched to the first hitching position of the unwinder.

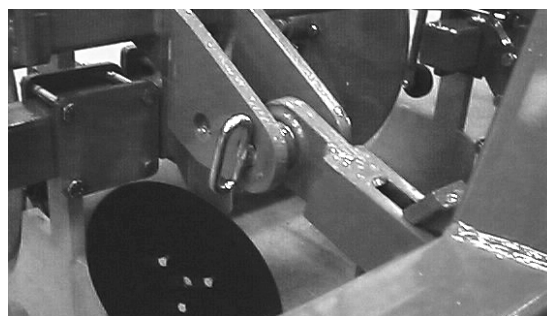



Operation:

Hitch the machine to the tractor (hand brake on) using the three attachment points, each time making sure that the hitch is in good condition and that the locking pins are present. Installation is simple and practical, all that is necessary is to place the reel of plastic film on the carrier wheels, pass it under the film grip rollers and the film is pulled down to the ground as the machine advances. Two shares at the front cut the ground at the required width, the two metallic wheels insert the plastic film at the bottom of the groove and the two rear wheels compress the earth to hold the film in the earth.

Maintenance:

Regularly grease the circular colter hubs and the hubs of the various wheels. Oil hinges. Wash the assembly after each use, especially if the machine is to be put into storage for a long period.

ADJUSTMENTS FOR FLAT UNWINDER

- Always adjust the metallic wheels to be parallel to the longitudinal members to prevent the film from shifting to one side during placement. This is done using the pivots of each wheel axis.
- Adjust the shares to be along the wheel axis by adjusting the attachment flanges.
- Leave between 10 and 15 mm of clearance between the share and the wheel.
- Move the wheel by about 15 to 20 mm from the tip of the share (height adjustment of the rear wheels).
- Move the rear wheel away from or closer to the metallic wheel depending on the nature of the ground (further apart for sticky or stony ground, closer for sandy ground).

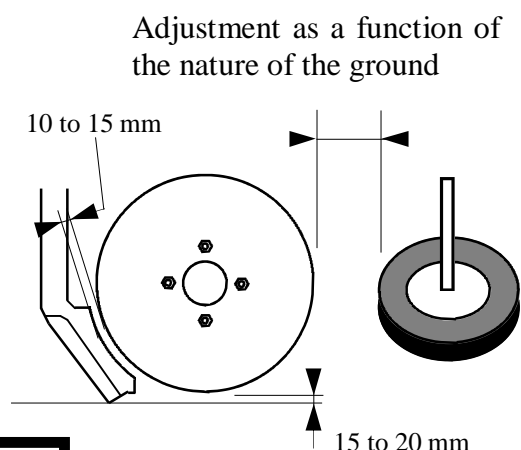



TECHNICAL DATA

- Category 2 3-point hitch
- Overall width 2.35 m
- Overall length 1.75 m
- Weight 420 kg
- Minimum tractor power 25 HP
- Adjustable working width 0.75 m to 1.70 m (max. plastic width 2.10 m)

DESCRIPTION

The plastic film unwinder comprises:

- a chassis adjustable in all positions with a 3-point hitch,
- two front circular colters,
- two shares,
- a set of plastic film application wheels,
- a reel brake,
- two rear wheels

EXPLANATIONS OF PICTOGRAMS



- YOU MUST READ THE MANUAL BEFORE USING THE MACHINE.

Any person using the machine or doing any work on it for any operation whatsoever, must be familiar with the different instructions specified in the manual.

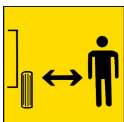

- REMAIN AT A DISTANCE FROM THE MACHINE WHEN IT IS IN OPERATION

Do not get close to the machine when it is in operation or when travelling on the road or in the fields.



- SWITCH THE ENGINE OFF BEFORE DOING ANY WORK ON THE MACHINE

Always switch the tractor engine off before doing any adjustment or maintenance work on the machine, to prevent the clutch from accidentally being engaged.





SAFETY INSTRUCTIONS SPECIFIC TO THE D.I. TYPE UNWINDER

Equipment conform with the Ministry of Labor regulations

- Always switch the tractor ignition off during reel placement operations and when passing the plastic film under the wheels, to prevent any accidental movement. The tractor driver must not start the tractor hydraulic lift under any circumstances.
- When the film cutter (option) is being used, the driver must make sure that the maneuver can take place without any risk for the person doing the work or for the equipment. Since the harrow is lowered quickly, there must be no-one close to the machine.
- For machines equipped with a film cutter, the safety valve must be switched off whenever doing any work on the machine. The film cutter safety valve must not be opened except during continuous operation of the machine. If the plastic film is not pushed under the wheels when starting a covering operation, the valve must be closed before the film is put into place. Open the valve again once the operation is finished.
- Whenever doing any work on the hydraulic circuit of machines fitted with a film cutter, it is essential that the harrow should be lowered to the ground before disconnecting the hydraulic couplers from the tractor.
- When positioning reels on the machine, allow for the weight of the reels and the risks of hands getting caught between the reel and the machine frame. It is strongly recommended that handling gloves should be worn during these operations.



GENERAL SAFETY STANDARDS

Equipment conforming with the Ministry of Labor regulations

Before using the machine, please read the instructions contained in the maintenance book carefully and also make sure that persons using the equipment have read them. Always take special care to respect personnel safety when using the equipment.

Use a stable and flat location for storage and for unhitching of the machine. When in the fields, make sure that the configuration and nature of the ground cannot cause an unbalance of the machine under any circumstances.

Do not hitch the machine before making sure that the machine hitch points and the tractor hitch points are in good condition. Switch the tractor engine off before hitching the machine to make sure that the clutch cannot be accidentally engaged and that no mechanical movement can endanger personnel.

Before moving the machine, make sure that there is no risk in moving it, by carefully checking the size of the machine, and signal before you start moving by sounding the horn.

The machine must not be approached or climbed on while it is moving on the road or when working in the field.

Do not start the machine without firstly making sure that it can be done without danger.

Never bring your hands close to any mechanisms or moving parts. If there is any blockage or jamming or for any technical problem whatsoever, stop the tractor to analyse the causes and correct them. Do not make any modifications to the machine without the written permission of the manufacturer.

Machines are supposed to move about during the day and under good visibility conditions. They must not conceal tractor lights, therefore if necessary install a lighting strip to display a second set of stop lights, indicating lights, etc. Whenever moving at night, make sure that the lights comply with the highway code in force in the country of use.



C.E. DECLARATION OF CONFORMITY

For equipment subject to autocertification

The undersigned manufacturer, "CM" - 31 Route de la Loire BP 2 – 44450 LA CHAPELLE BASSE MER - Tel 02 40 03 66 60 declares that the new equipment designated below:

PLASTIC FILM FLAT UNWINDER DI TYPE Réf 730-ID-10

Type :

Serial number :

PLASTIC FILM ON ARCHES UNWINDER DI TYPE Réf 750-ID-10

Type :

Serial number :

complies with the Labor Health and Safety Rules applicable to it.

Prepared in La Chapelle Basse Mer, date

Signature,



PLASTIC FILM UNWINDER DI TYPE

INSTRUCTIONS



November 2001 edition



CM
31, route de la Loire - BP 2
44450 La Chapelle-Basse-Mer
Tél. : 02 40 03 66 60
Fax : 02 40 03 64 73